

Adventurer Single-level Step with Battery

Instructions on Installation and Use

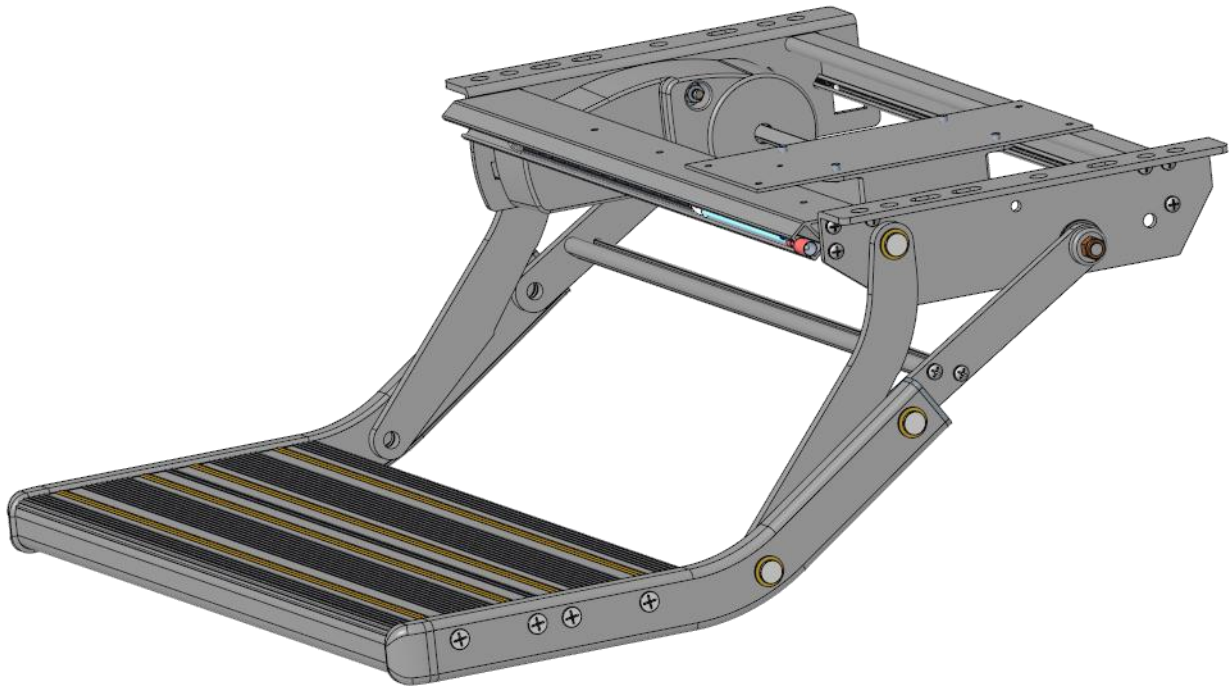

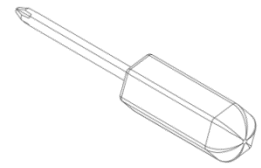
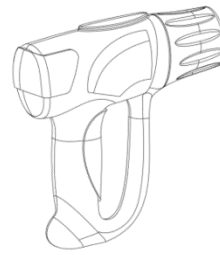
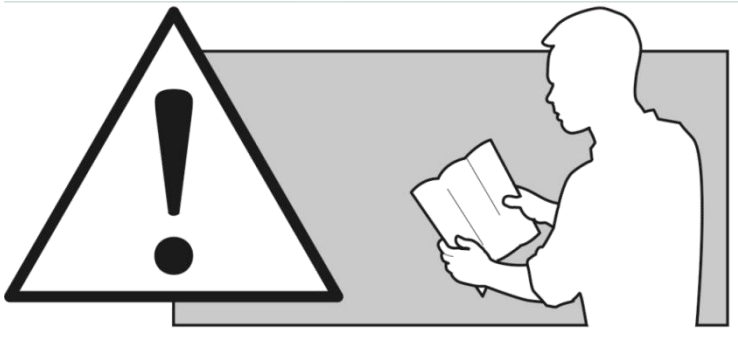

Tool

Overall

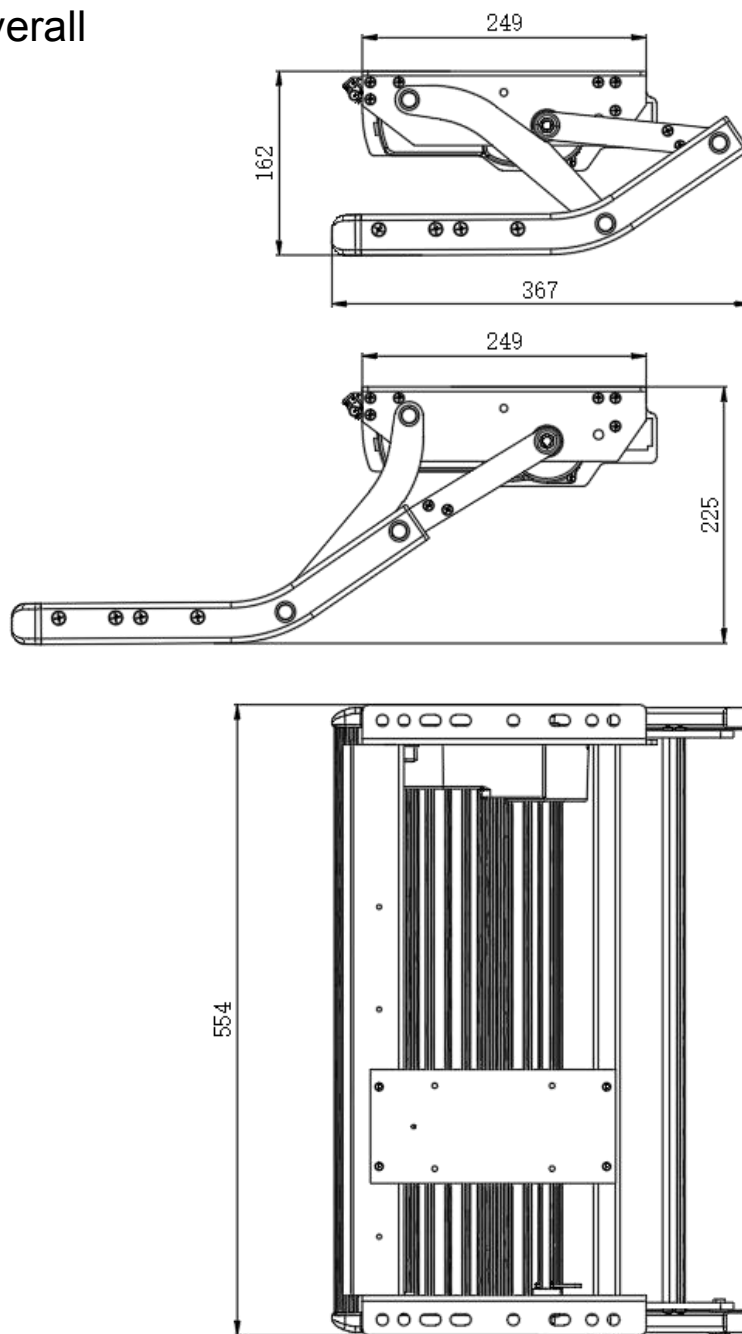

Instructions on Installation:

- 1. Step 1: Drilling holes and positioning of the step assembly for installation (Refer to Figure 1)**
 - (1) Fix the step assembly to the horizontal beam of the chassis with outer hex screws (M8) and gaskets (not supplied with the step assembly).
 - (2) The width required for installing the step assembly: 527mm.
- 2. Step 2: Drilling holes and positioning of the step assembly for installation;**

Note: The step assembly should be secured to the horizontal beam with hex bolts (M8), gaskets and lock nuts with a mounting torque of 25N.m.

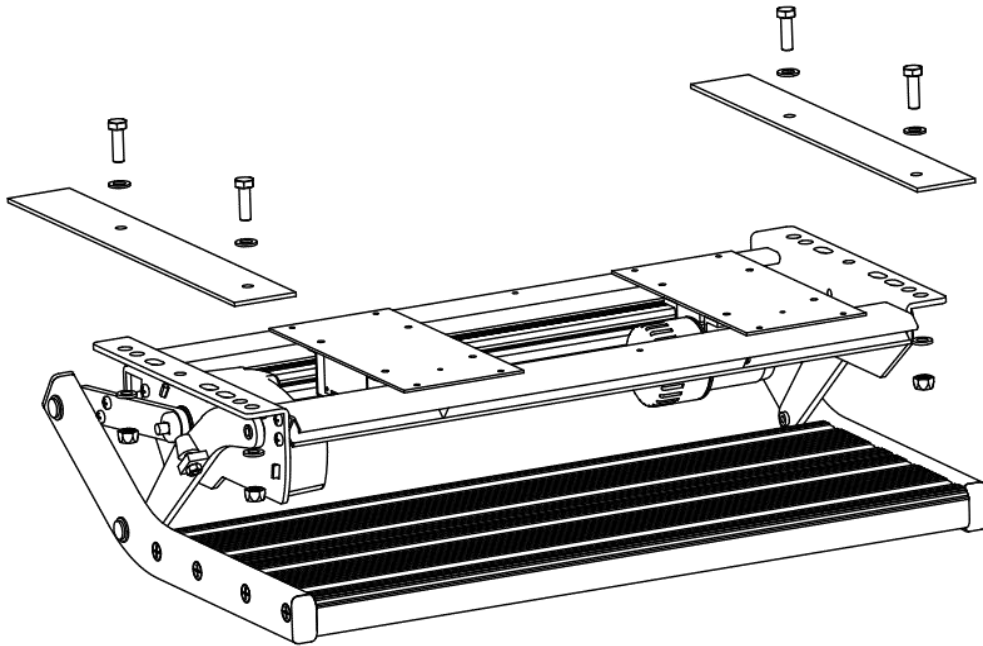

- 3. Step 3: Put the battery cover in place with the left hand through space in the step assembly and turn the cover to fasten it;**



- 4. Step 4: Put the battery into the battery along the notch position, with the electrodes upwards. Then tighten the battery box cover. Check that the sealing ring is place;**



Electrode

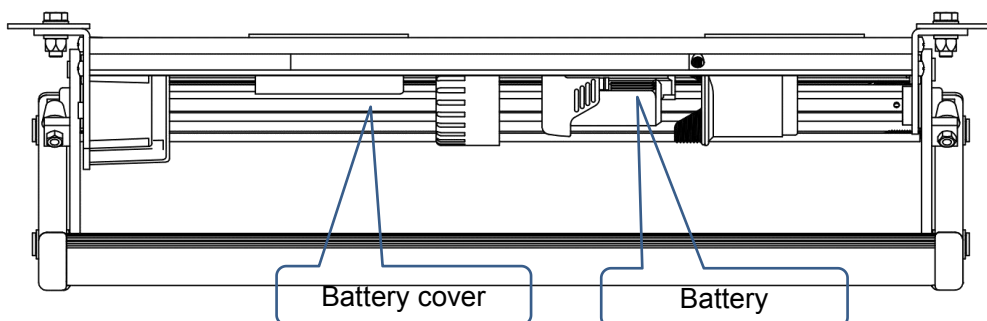

5. Step 5: Installing the waterproof switch and test the step assembly after installation.

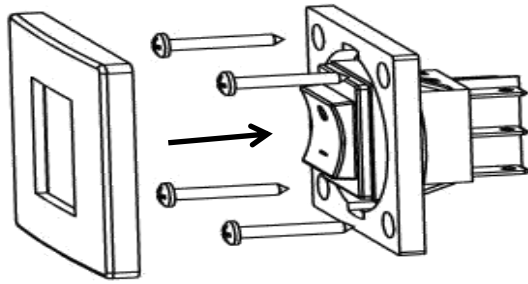
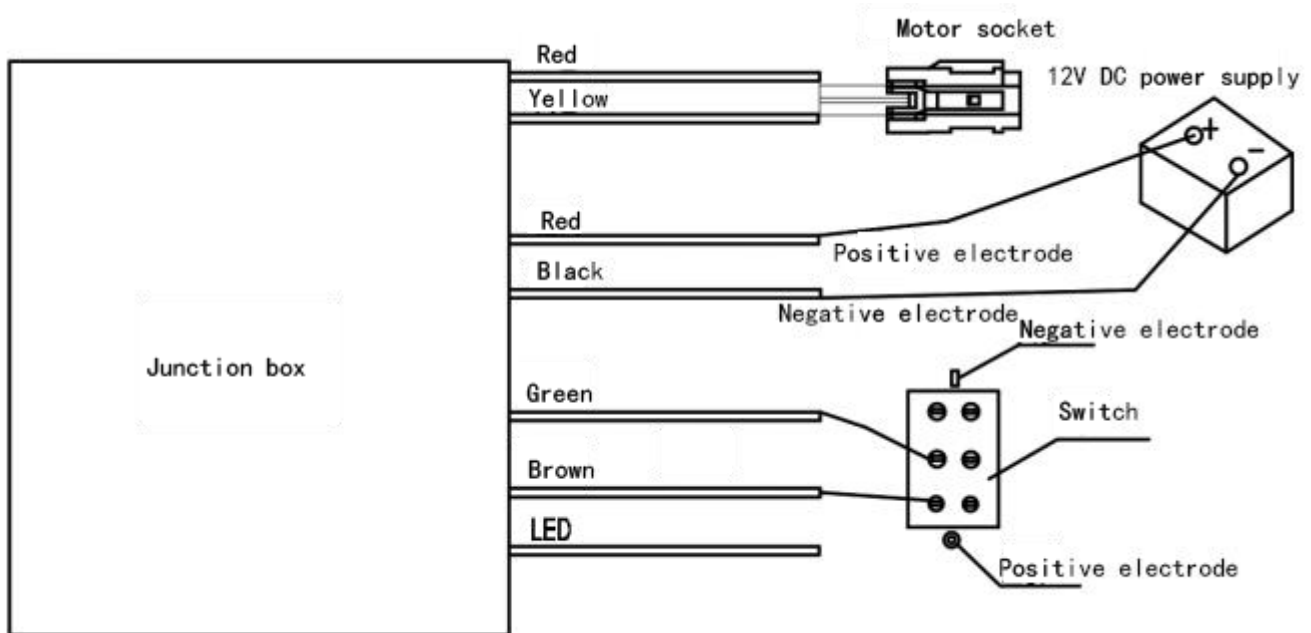

Illustration of circuit board

Diagram of circuit board:



1. First, connect the junction box to the 12VDC power supply and related leads according to the diagram.
2. Press the “on” end of switch knob while the step assembly is withdrawn, and the step assembly will extend and the LED lamp will be on (the lamp will automatically turns off after 5 minutes if the switch remains extended). When the step assembly fully extends, the power supply to the motor will be cut off and the step assembly will remain withdrawn.
3. Press the “off” end of the switch knob, and the step assembly will withdraw and the LED lamp on the step will turn off (if it has been on). When the step assembly withdraws completely, the power supply to the motor will be cut off and the step assembly will remain withdrawn.
4. If the switch is pressed to the neutral state, the LED lamp will go off and the step will remain in the same position.

Regular Maintenance Instructions

In case, there is too much sand and dust, which will increase the resistance and makes the mechanical movement of the product ineffective, the following maintenance work shall be done:

1. The step should be flushed regularly, to avoid accumulation of sand and mud;
2. Lubricating oil should be applied to the shafts of the step every month;
3. When using the step, do check that the step fully extends before stepping on it (in case that the motor mechanism might be damaged);
4. When fully extended, the maximum bearing capacity of the step is 200/KG;
5. Rated voltage 12V; maximum power: 180W.