

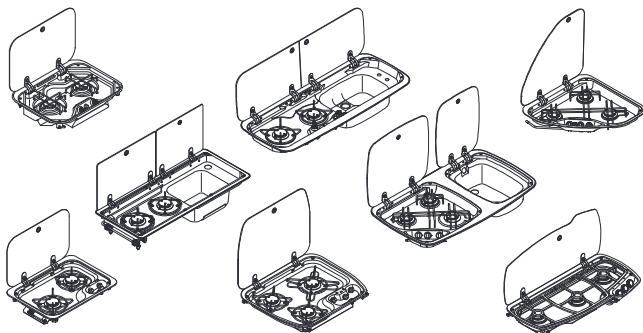

HOT AND COOKING HOBS AND COMBINATIONS



CE99-DF (HBG 3445), CE99-ZF (HBG 2335), KSK2007R, MO7103, MO7123,
MO9222L (HSG 2370L), MO9222R (HSG 2370R), MO9722L, MO9722R, PI8002,
PI8022, PI8023, PI9003, PI9023

EN	Cooktops and combinations Installation and Operating Manual	SV	Spishällar och kombinationer Monterings- och bruksanvisning
DE	Kochfelder und Kombinationen Montage- und Bedienungsanleitung	NO	Kokeplater og kombinasjoner Monterings- og bruksanvisning
FR	Plaques de cuisson et combinaisons Instructions de montage et de service	FI	Liedet ja liesi-tiskiallasyhdistelmät Asennus- ja käyttöohje
ES	Placas de cocina y combinaciones Instrucciones de montaje y de uso	RU	Варочные панели и комбинации Инструкция по монтажу и эксплуатации
PT	Placas e combinações Instruções de montagem e manual de instruções	PL	Płyty grzewcze i kombinacje Instrukcja montażu i obsługi
IT	Piani cottura e combinazioni Istruzioni di montaggio e d'uso	SK	Variče a kombinácie Návod na montáž a uvedenie do prevádzky
NL	Kookplaten en combinaties Montagehandleiding en gebruiksaanwijzing	CS	Varné desky a kombinace Návod k montáži a obsluze
DA	Kogetoppe og kombinationer Monterings- og betjeningsvejledning	HU	Főzőlapok és kombinációk Szerelési és használati útmutató

© 2020 Dometic Group. The visual appearance of the contents of this manual is protected by copyright and design law. The underlying technical design and the products contained herein may be protected by design, patent or be patent pending. The trademarks mentioned in this manual belong to Dometic Sweden AB. All rights are reserved.

NOTICE



1

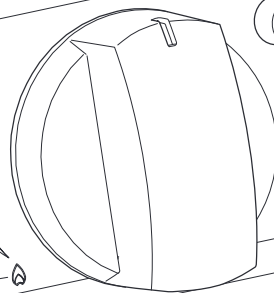
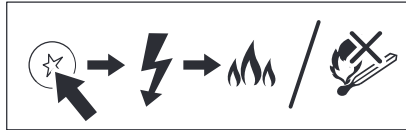
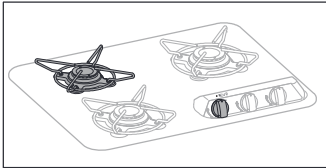

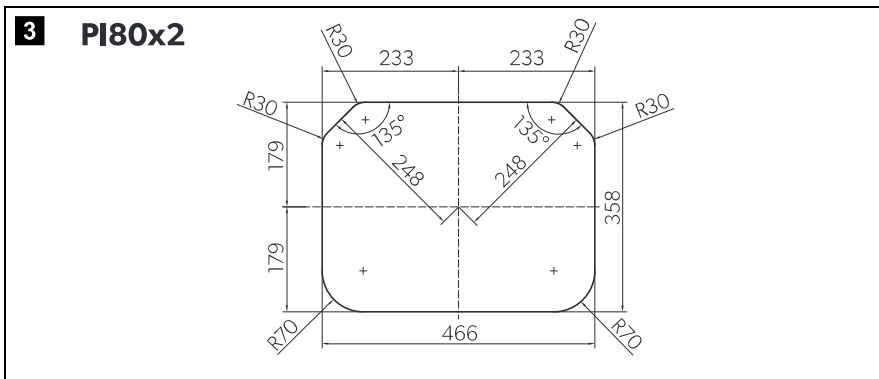
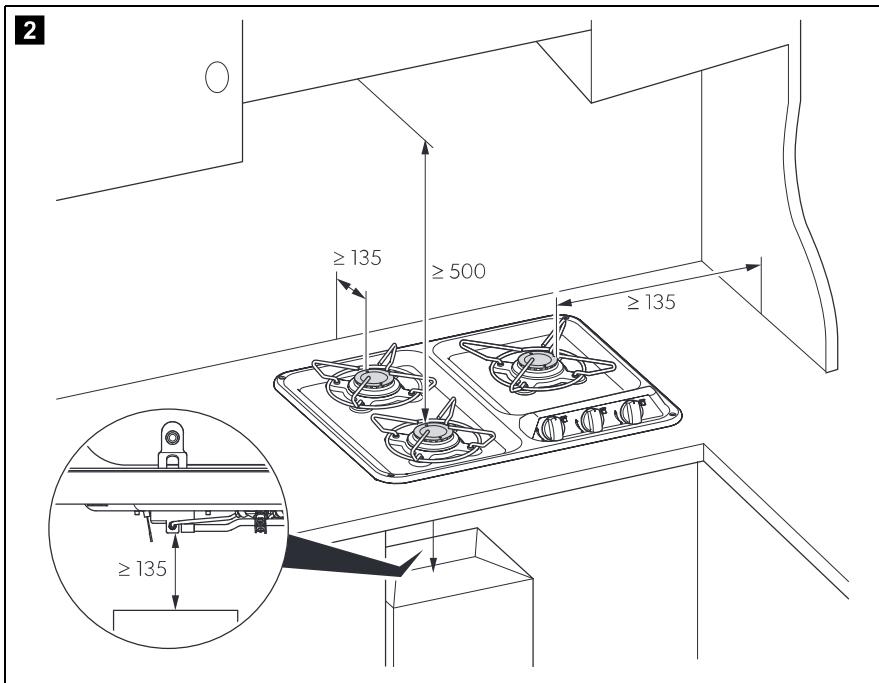

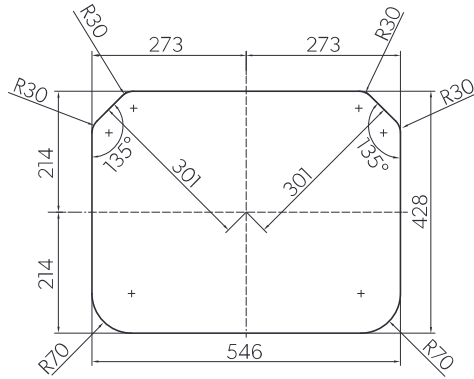
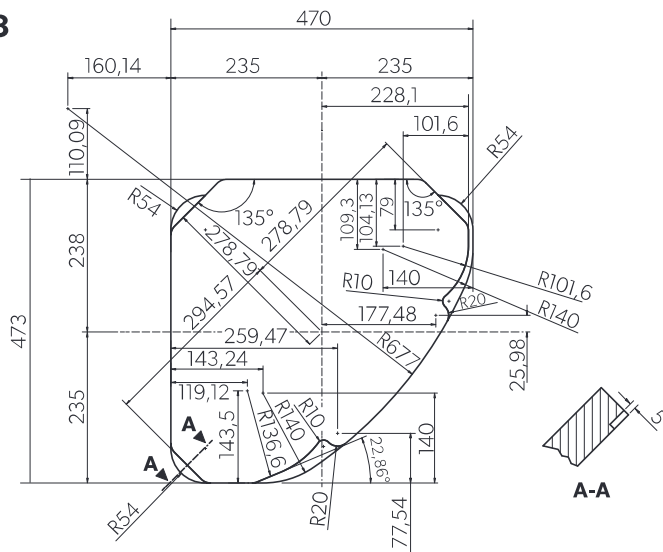
4 PI80x3 (HBG3440)**5 PI90x3**

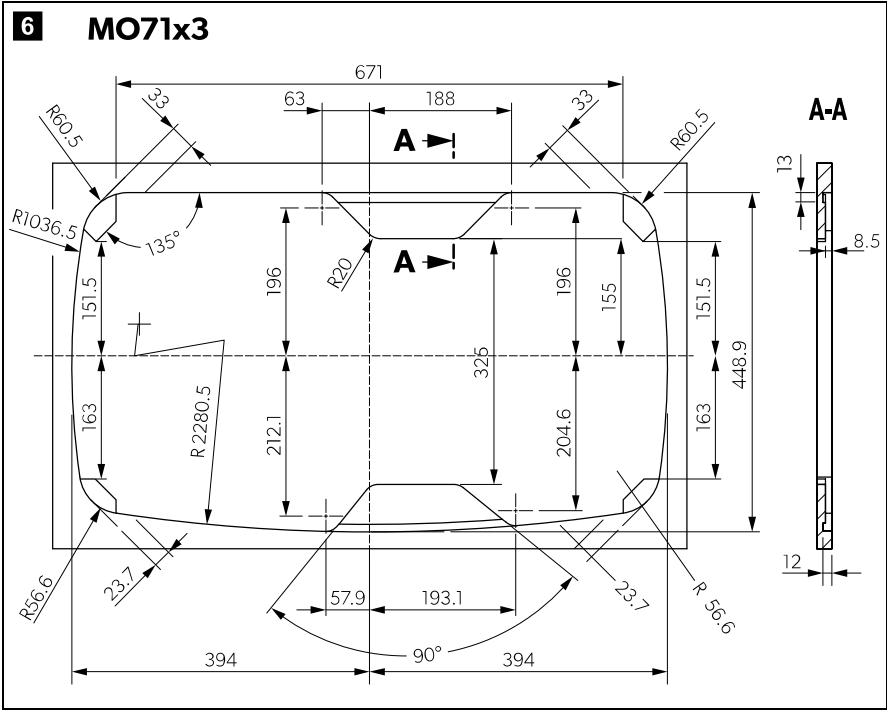

8 MO9722R

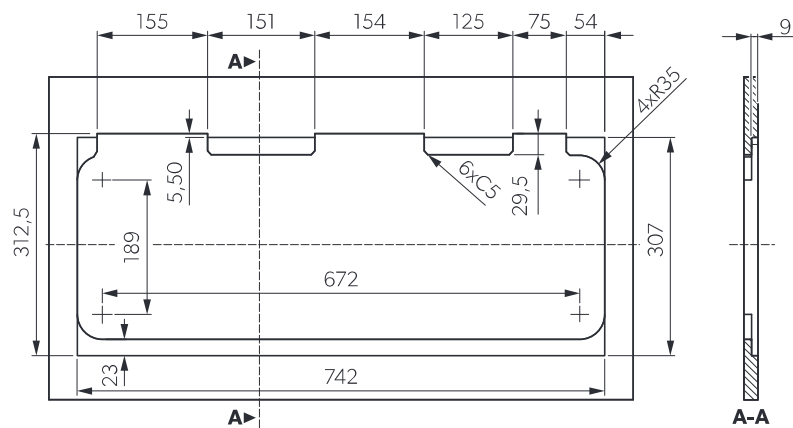

MO9722L

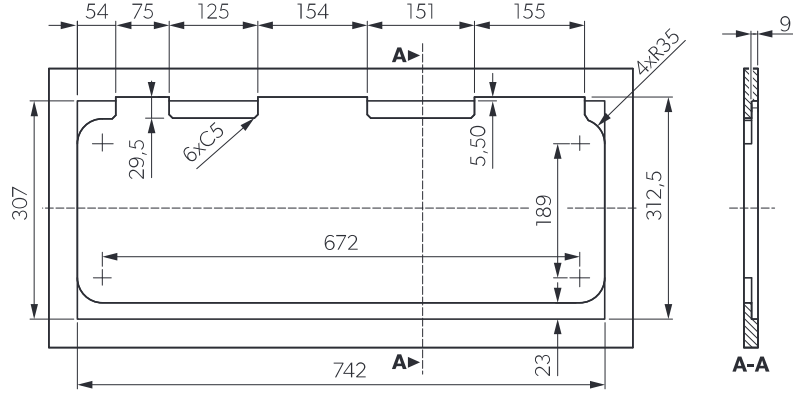

9 CE99-ZF (HBG2335)

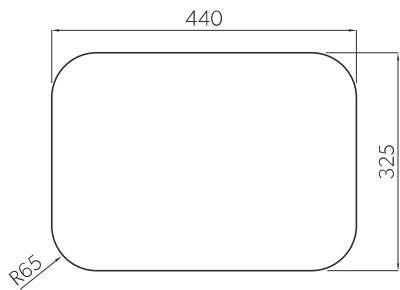

10 CE99-DF (HBG3445)

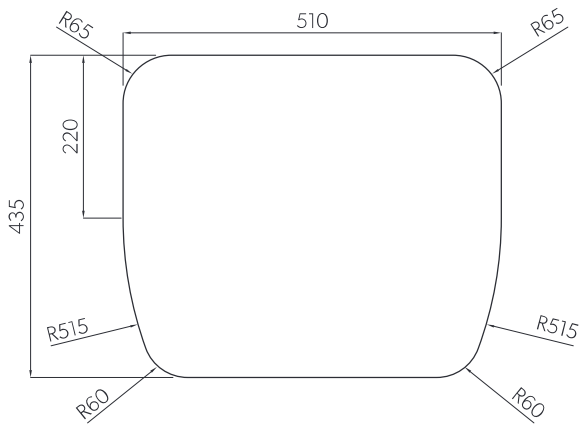

11 KSK2007R

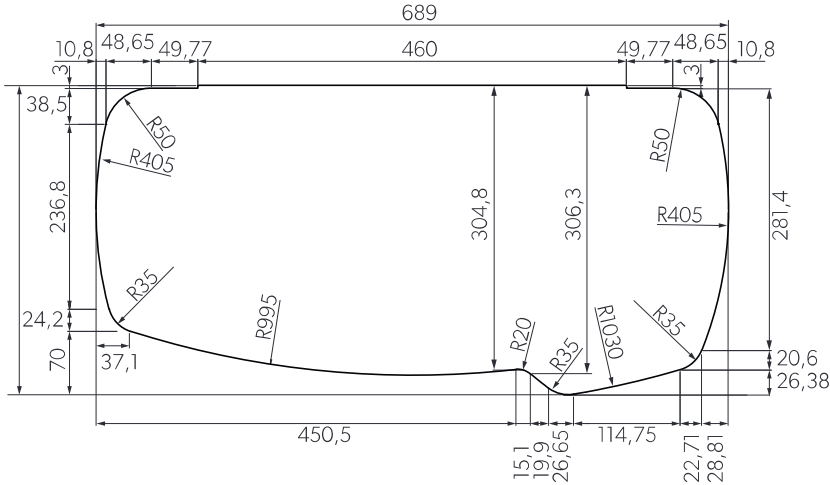

12

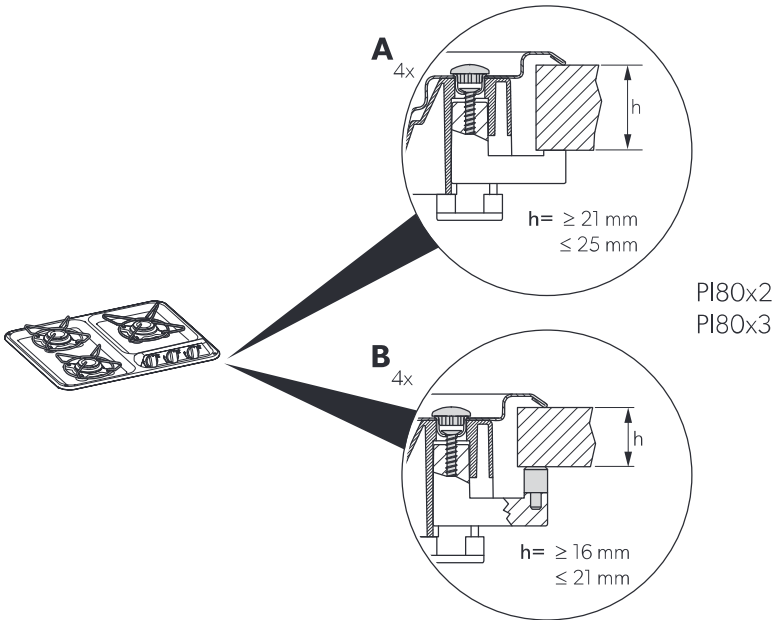

13

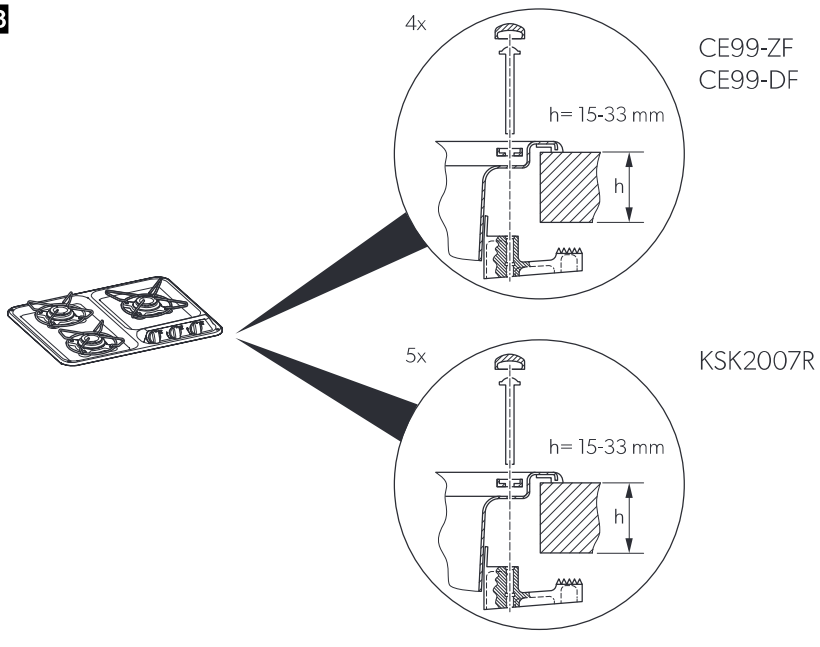

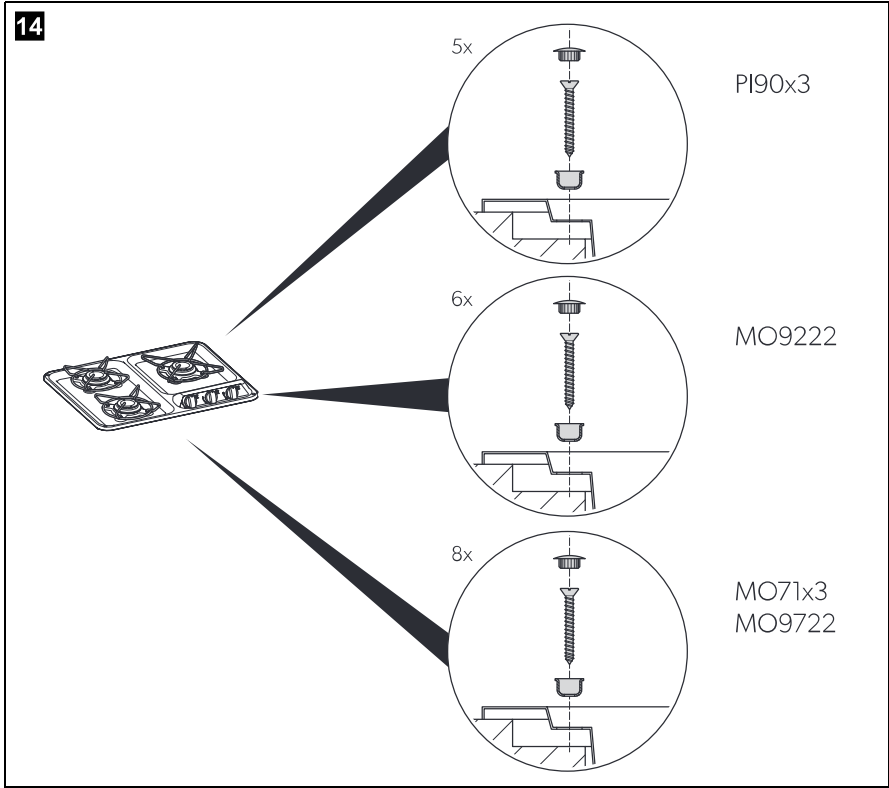

15

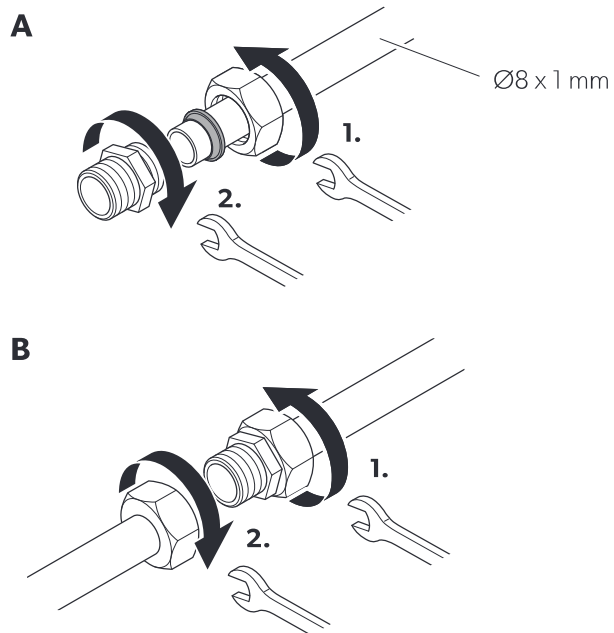

16

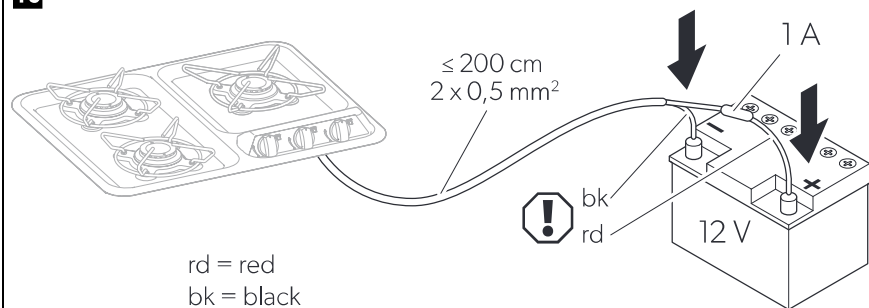

17

PI80X2

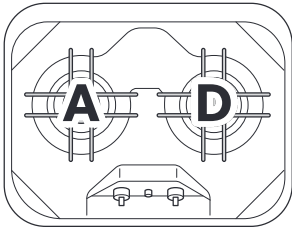

MO9222R

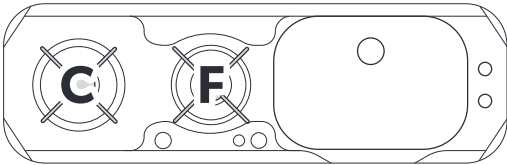

MO9222L

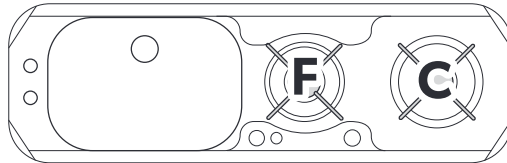

PI80X3 (HBG3440)

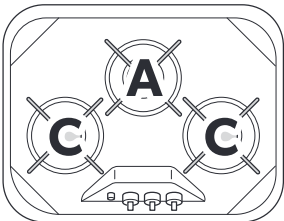

MO9722R

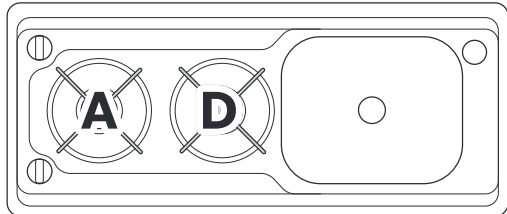

PI90X3

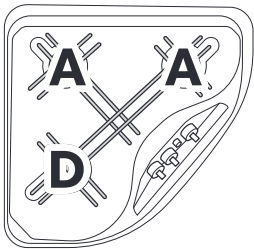

MO9722L

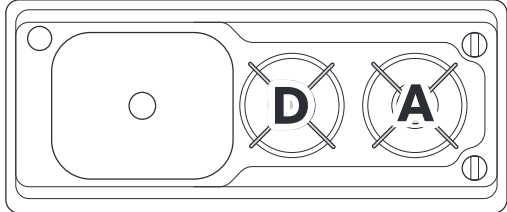

MO71X3

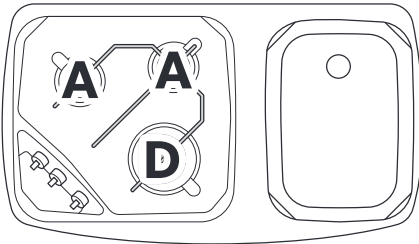

18 CE99-ZF (HBG2335)

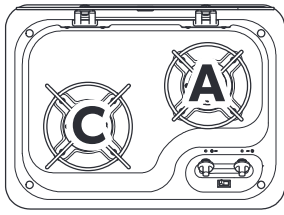

CE 99-DF (HBG3445)

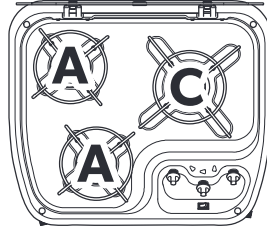

KSK2007R

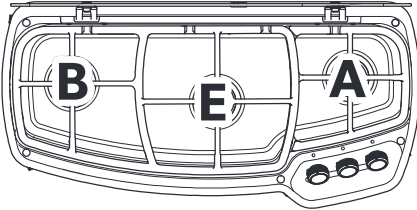

19

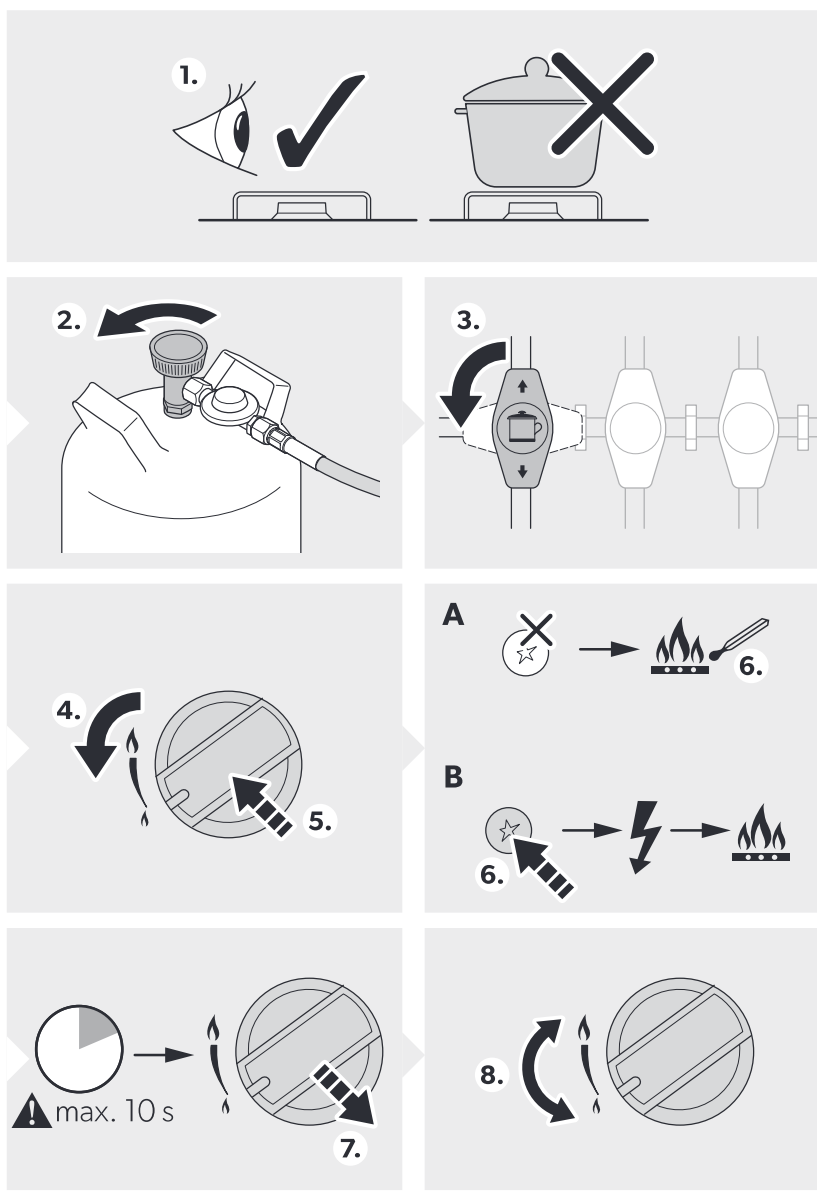

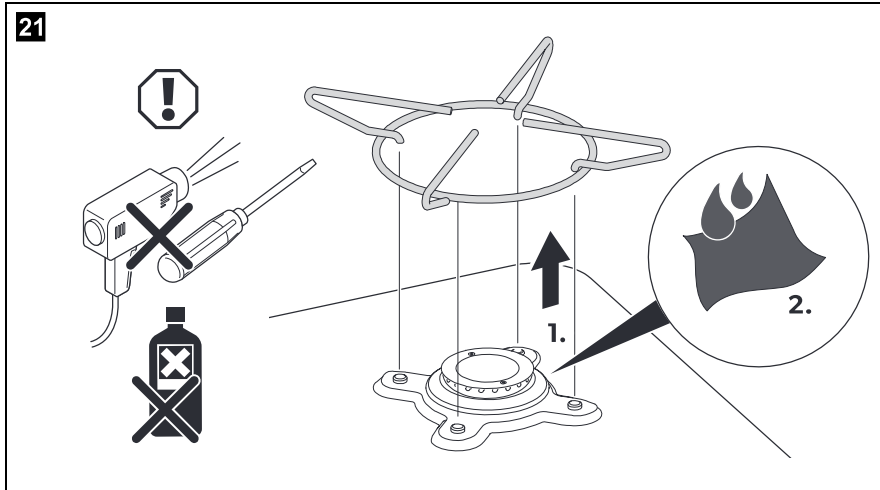
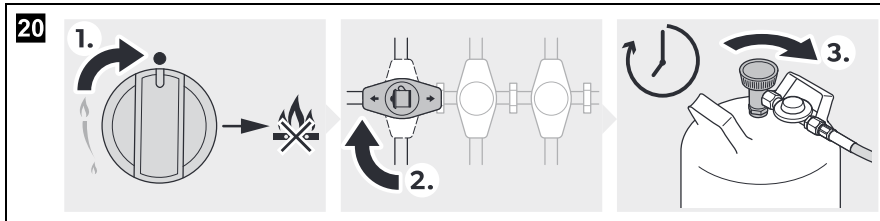

22

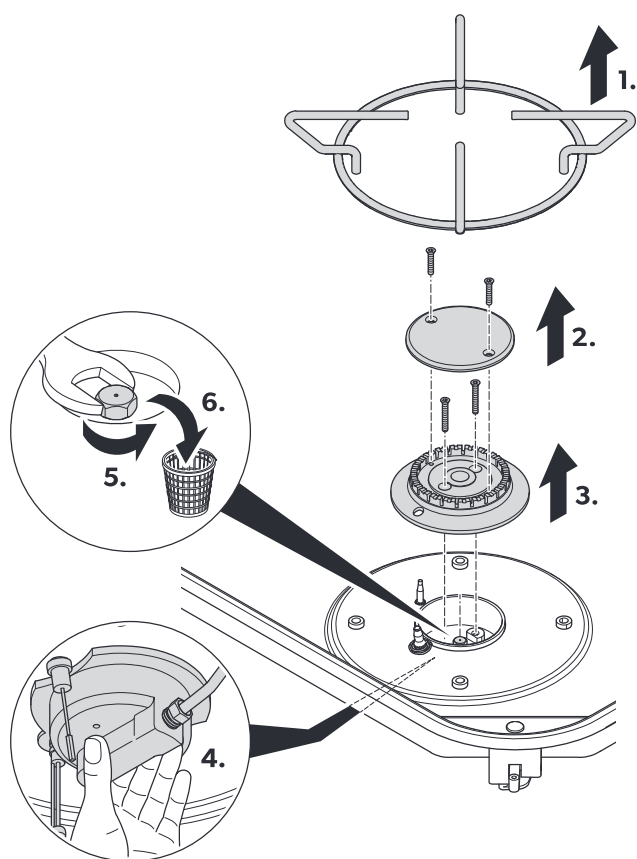

23

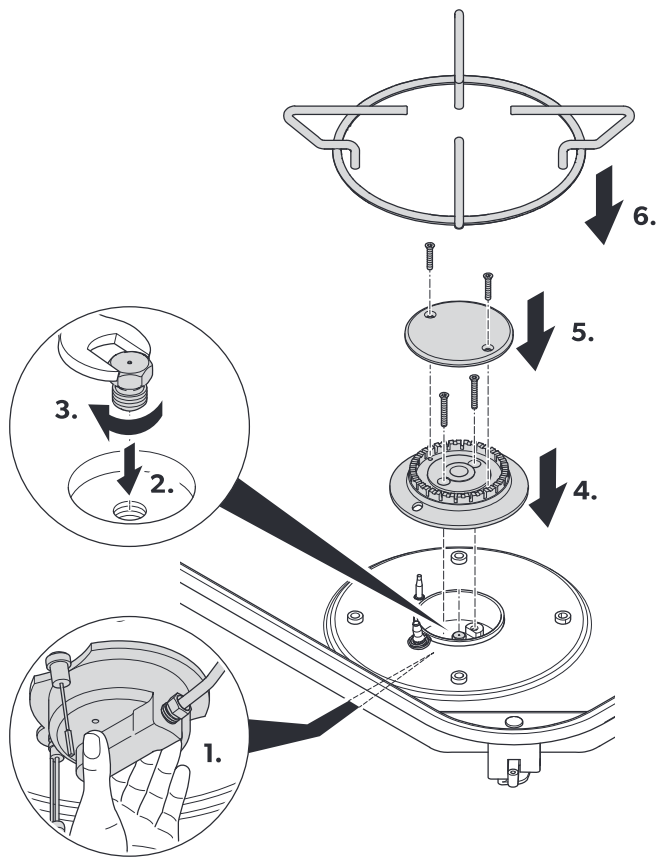

Please carefully read and follow all instructions, guidelines and warnings included in this product manual in order to ensure that you install, use and maintain the product properly at all times.

By using the product, you hereby confirm that you have read this disclaimer, all instructions, guidelines and warnings carefully and that you understand and agree to abide by the terms and conditions as set forth herein.

You agree to use this product only for the intended purpose and application and in accordance with the instructions, guidelines and warnings as set forth in this product manual as well as in accordance with all applicable laws and regulations.

A failure to read and follow the instructions and warnings set forth herein may result in an injury to yourself and others, damage to your product or damage to other property in the vicinity.

Dometic accepts no liability for any loss, damage or injury incurred, directly or indirectly, from the installation, use or maintenance of the product not in compliance with the instructions and warnings in the product manual.

This product manual, including the instructions, guidelines and warnings, and related documentation may be subject to changes and updates. For up-to-date product information, please visit: documents.dometic.com, dometic.com.

Contents

1	Description of symbols	20
2	General safety instructions	21
3	Scope of delivery	24
4	Intended use	24
5	Technical description	25
6	Installing the device	25
7	Using the device	27
8	Cleaning the device	29
9	Maintaining the device	29
10	Warranty	30
11	Disposal	30
12	Technical data	30

1 Description of symbols



WARNING!
Safety instruction: Indicates a hazardous situation that, if not avoided, could result in death or serious injury.



CAUTION!
Safety instruction: Indicates a hazardous situation that, if not avoided, could result in minor or moderate injury.

**NOTICE!**

Indicates a situation that, if not avoided, can result in property damage.

**NOTE**

Supplementary information for operating the product.

2 General safety instructions

The manufacturer accepts no liability for damage in the following cases:

- Faulty assembly or connection
- Damage to the product resulting from mechanical influences
- Alterations to the product without express permission from the manufacturer
- Use for purposes other than those described in the operating manual

2.1 General safety

**WARNING!**

- This device must only be repaired by qualified personnel. Improper repairs can result in considerable danger or damage to the device.
- Do not modify this device.
- Observe the gas category and the allowed gas given in chapter “Technical data” on page 30. Do **not** use any other fuels.
- Keep a suitable fire extinguisher in the immediate vicinity. Ensure that the fire extinguisher is checked by a specialist in regular intervals.
- Do not use or store flammable materials in the device storage drawer or near this device.
- Prior to installation, ensure that the local distribution conditions (nature of the gas and gas pressure) and the adjustment of the device are compatible.
- The adjustment conditions for this device are stated on the label.
- This device is not connected to a combustion products evacuation device. It shall be installed and connected in accordance with current installation regulations. Particular attention shall be given to the relevant requirements regarding ventilation.

**CAUTION!**

- In case of safety glass cover breakage:
 - Shut off immediately all burners and any electrical heating element and isolate the device from the power supply.
 - Do not touch the device surface.
 - Do not use the device.

2.2 Safety when operating with gas

**WARNING!**

- Keep flammable substances away from heating and cooking devices, and other light and heat sources.
- **Suffocation hazard!**
Before switching on the device, ensure that the area is sufficiently ventilated. During operation, there must be air vents with a cross-section of at least 150 cm² in the installation space. These vents can be closed, but must be kept open when the device is operating (see sign located above the device).
- **Only** operate the device at the pressure specified on the type plate. Only use pressure regulators with a fixed setting that comply with the national regulations.
- Compare the pressure information on the type plate with the pressure information on the propane or butane gas cylinder.
- If you smell gas:
 - Open all windows and leave the room.
 - Do not operate any electrical devices or switches, and avoid using open flames that can ignite the gas.
 - Close the valve on the gas cylinder and keep it closed until the fault has been rectified.
 - Never attempt to find a gas leak with an open flame.
- For countries which are not mentioned in chapter “Technical data” on page 30 (country symbol) refer to national regulations. If necessary the device must be modified according to these national regulations.

2.3 Operating the device safely



WARNING!

- Use the integrated igniter (if available) or long matches or a suitable lighter. The complete ignition process must be visible from above and must not be hidden by pots placed on the stove. Remove your hand quickly as soon as the burner ignites.
- Wear suitable clothing when operating the device. Do not wear loose fitting clothing which might catch fire.
- Do not use the device to heat the room.
- Never operate the device
 - at petrol stations
 - on ferry boats
 - while transporting the camper van, caravan or motor caravan with a transport vehicle or tow truck
- Do not spray aerosols in the vicinity of this device while it is in operation.



CAUTION!

- Let the device cool down to ambient temperature before you touch it with bare hands.
- Keep the area surrounding the device free of grease, fat, alcoholic substances, plastics and flammable cloths (for example, curtains, towels, kitchen utensils).
- Only use pots and pans with an even base and a diameter no larger than the grids on the device. The pots and pans must be large enough to cover the flame. If the flames are not covered, items of clothing could catch fire.
- When cooking, ensure that pans and pots are firmly set down.
- Never allow pot handles to extend beyond the edge of the device. Turn pot handles inward, but not extending over other burners. This will minimize the risk of spillage, ignition of flammable materials and/or serious burns.
- Be careful when heating grease or oil. Grease and oil catch fire when exposed to intense heat.
- Use only dry pot holders to prevent the formation of steam. Do not use towels or similar items instead of pot holders, as these can catch fire.
- Only operate the device when you or another person can attend to it. Pots boiling over can cause smoke and fires.

- Turn off the device before removing the pot or pan.
- **Risk of breakage!**
If available close the glass cover before beginning a journey. Open the glass cover before igniting the burner.

3 Scope of delivery

- Cooktop (PI80xx, PI90x3, CE99-DF, CE99-ZF, KSK2007R)
Combination (MO71x3, MO9x22)
- Fastening screws (depending on the model)
- Siphon and rubber seal (depending on the model)
- Installation and operating manual

4 Intended use

The liquefied gas cooktops in the following model series are intended for installation in a kitchen or worktop in caravans and motor caravans. They are **not** suitable for boat or marine usage.

The model series covered by this manual are:

- PI80x2
- PI80x3 (HBG3440)
- PI90x3
- MO71x3
- MO9x22
- CE99-DF (HBG3445)
- CE99-ZF (HBG2335)
- KSK2007R

The devices must only be used for cooking food. The device must **not** be used as a space heater.

This device shall be installed in accordance with the regulations in force and only used in a well ventilated space. Read the instructions before installing or using this device.

This product is only suitable for the intended purpose and application in accordance with this instruction. Any other use, deviating from the intended use, is not allowed! Dometic accepts no liability for any loss, damage or injury incurred, directly or indirectly due to other as the intended use.

5 Technical description

5.1 Function

The device is equipped with an automatic flame monitoring device which automatically interrupts the gas supply after approx. 20 seconds if the flame goes out.

5.2 Specifications for the different models

The devices are available in different versions:

- **CE99-ZF:** Cooktop with two burners and safety glass cover
- **PI80xx:** Cooktop with two to three burners and safety glass cover
- **CE99-DF:** Cooktop with three burners and safety glass cover
- **KSK2007R:** Cooktop with three burners and safety glass cover
- **PI90x3:** Cooktop with three burners and safety glass cover
- **MO71x3:** Combination with three burners, safety glass cover and a sink
- **MO9x22:** Combination with two burners, safety glass cover and a sink

The safety glass cover can be used as a work surface when it is closed.

5.3 Control panel

See fig. **1**, page 3

6 Installing the device



WARNING!

Assembly and installation of the device must only be carried out by specialists. Incorrect assembly and installation can result in serious hazards due to the escape of gas.

6.1 Selecting the installation location

When selecting the installation location, observe the following instructions:

- Consider the volume of air required for combustion (chapter “Technical data” on page 30).
- During operation, there must be air vents with a cross-section of at least 150 cm² in the installation room.
- Make sure that minimum distances (fig. **2**, page 4) are observed.
- Ensure that there are no drafts at the installation location.

6.2 Installing the device

- Create a cutout according to the installation drawing:
 - PI80x2: fig. **3**, page 4
 - PI80x3: fig. **4**, page 5
 - PI90x3: fig. **5**, page 5
 - MO71x3: fig. **6**, page 6
 - MO9222: fig. **7**, page 7
 - MO9722: fig. **8**, page 8
 - CE-99-ZF: fig. **9**, page 9
 - CE99-DF: fig. **10**, page 9
 - KSK2007R: fig. **11**, page 10
- Affix the device to the worktop using the screws (fig. **12**, page 10 – fig. **14**, page 12).

6.3 Connecting the device to the gas supply



WARNING! Beware of injury!

Only use propane or butane gas cylinders with a certified pressure reduction valve and suitable head. Compare the pressure information on the type plate with the pressure information on the propane or butane gas cylinder.

You must use a rigid gas line for the connection.

Observe the following instructions for the connection:

- Observe the national requirements.
- Use only steel pipe Ø8 x 1 mm (welded, seamless steel or stainless steel)

- Fasten the gas line to the side or rear wall of the surrounding furniture parts so that no loads are placed on the actuators.
- The entire gas line must be free of stress.
- Connect the pipes as shown (fig. **15**, page 13).
- Attach a sign above the device with the following text:
“WARNING!
When cooking, additional ventilation must be provided, for example, by opening windows near the device.
The device must not be used as a space heater.”
- Open the gas supply.

**WARNING! Beware of injury!**

Never check for leaks with an open flame or near sources of ignition.

- Check all connections for leaks with leak spray.
There are no leaks if no bubbles form.

6.4 Connecting the device to the power supply (models with electronic ignition only)

- Connect the device as shown (fig. **16**, page 13).
- Add a 1 A fuse in the plus line near the battery.

7 Using the device

7.1 Igniting a burner



**WARNING! Beware of injury!**

The complete ignition process must be visible from above and must not be hidden by pots placed on the stove.

**NOTICE!**

The flame must not extend beyond the edge of the pot. Centre the pot above the burner ensuring stability on the pot grid (see page 3).

- Choose a pot according to the following table:

Burner (fig. 17, page 14 – fig. 18, page 15)		Pot diameter
A – B, F	9 – 15 cm	
C	10 – 18 cm	
D, E	16 – 22 cm	

- Ignite a burner as shown (fig. 19, page 16).

7.2 Switching off the device

- Switch off the device as shown (fig. 20, page 17).

7.3 Replacing the gas cylinder



WARNING! Beware of injury!
Only replace the gas cylinder when there is good ventilation.
Make sure that there is no source of ignition nearby.
Only change the gas cylinder when the device is not in use and the gas supply to the device is switched off.

- Switch the device off by turning the knob to the zero setting.
- Close the valve on the gas cylinder.
- Replace the gas cylinder according to the instructions from the gas fitting manufacturer.

8 Cleaning the device

**CAUTION! Hot surface!**

The surface may still be hot. Keep children away.
Let the device cool down to ambient temperature before you touch it with bare hands.

**NOTICE!**

Do not use any sharp or hard objects for cleaning since they may damage the device.
Only use standard commercial cleaning agents.
Do not use a steam cleaner to clean the device.

- Clean the device as shown (fig. **21**, page 17).

9 Maintaining the device

9.1 Annual safety check

- For safety reasons, have the device checked by an expert every year for proper function. Any defects must be repaired.

9.2 Replacing the nozzles

**WARNING! Beware of injury!**

The nozzles must only be replaced by qualified specialists. Incorrect assembly and installation can result in serious hazards due to the escape of gas.

- Replace the nozzles as shown:
 - Disassembly: fig. **22**, page 18
 - Assembly: fig. **23**, page 19

10 Warranty

The statutory warranty period applies. If the product is defective, please contact your retailer or the manufacturer's branch in your country (see dometic.com/dealer).

For repair and warranty processing, please include the following documents when you send in the device:

- A copy of the receipt with purchasing date
- A reason for the claim or description of the fault

11 Disposal

- Place the packaging material in the appropriate recycling waste bins wherever possible.





If you wish to finally dispose of the product, ask your local recycling centre or specialist dealer for details about how to do this in accordance with the applicable disposal regulations.

12 Technical data

	Cooktop
Gas category:	Category I ₃ B/P(30)
Connection pressure:	BG, CY, DK, EE, FI, GR, HU, IS, LT, LV, MT, NL, NO, RO, SE, SI, SK, AL, HR, MK, TR: 30 mbar propane (G31) 30 mbar butane (G30)
Gas category:	Category I ₃₊ , propane/butane
Connection pressure:	BE, CH, CY, CZ, ES, FR, GB, GR, IE, IT, LT, PT, SI, SK, AL, MK, TR: 37 mbar propane (G31) 28 – 30 mbar butane (G30)
Connection voltage (models with electronic ignition only):	12 V $\overline{=}$ (1 A fuse)
Inspection/certification:	CE

See fig. **17**, page 14 – fig. **18**, page 15:



Model	Burner A 				Burner B 			
	*	**	***	****	*	**	***	****
PI80X2	0.53	1.1	80	79	–	–	–	–
PI80X3	0.53	1.1	80	79	–	–	–	–
PI90X3	0.53	1.1	80	79	–	–	–	–
MO9722L, MO9722R	0.53	1.1	80	79	–	–	–	–
MO71X3	0.53	1.1	80	79	–	–	–	–
CE99-ZF	0.53	1.1	80	79	–	–	–	–
CE99-DF	0.53	1.1	80	79	–	–	–	–
KSK2007R	0.53	1.1	80	79	0.57	1.3	95	93



* Injector mm

** Power kW

*** Gas consumption (G30) g/h

**** Gas consumption (G31) g/h

Model	Burner C 				Burner D 			
	*	**	***	****	*	**	***	****
PI80X2	–	–	–	–	0.69	1.8	131	129
PI80X3	0.65	1.6	116	114	–	–	–	–
PI90X3	–	–	–	–	0.69	1.8	131	129
MO9722L, MO9722R	–	–	–	–	0.69	1.8	131	129
MO9222L, MO9222R	0.65	1.6	116	114	–	–	–	–



Model	 Burner C				 Burner D			
	*	**	***	****	*	**	***	****
MO71X3	–	–	–	–	0.69	1.8	131	129
CE99-ZF	0.65	1.6	116	114	–	–	–	–
CE99-DF	0.65	1.6	116	114	–	–	–	–

* Injector mm

** Power kW

*** Gas consumption (G30) g/h

**** Gas consumption (G31) g/h

Model	 Burner E				 Burner F			
	*	**	***	****	*	**	***	****
MO9222L, MO9222R	–	–	–	–	0.50	1.0	73	71
KSK2007R	0.73	2.0	145	143	–	–	–	–

* Injector mm

** Power kW

*** Gas consumption (G30) g/h

**** Gas consumption (G31) g/h