

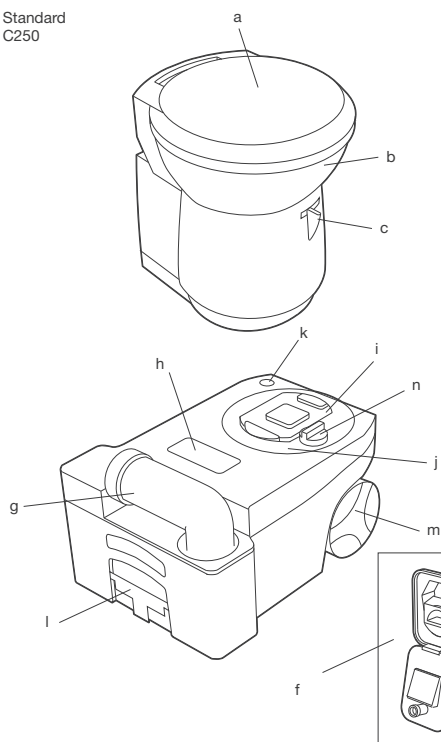

C-250

THETFORD
Loving leisure

Standard
C250



Additional Features
C250

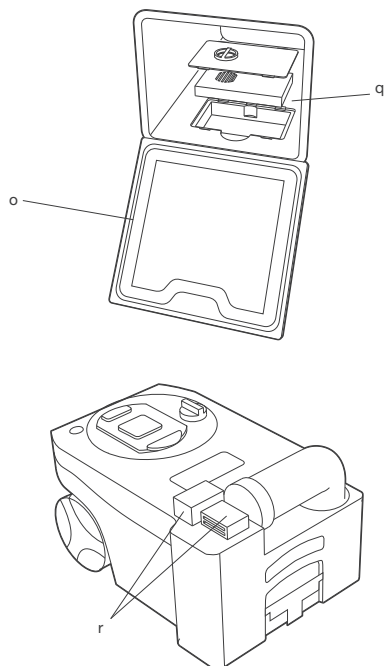

Controlpanel
(with additional features)

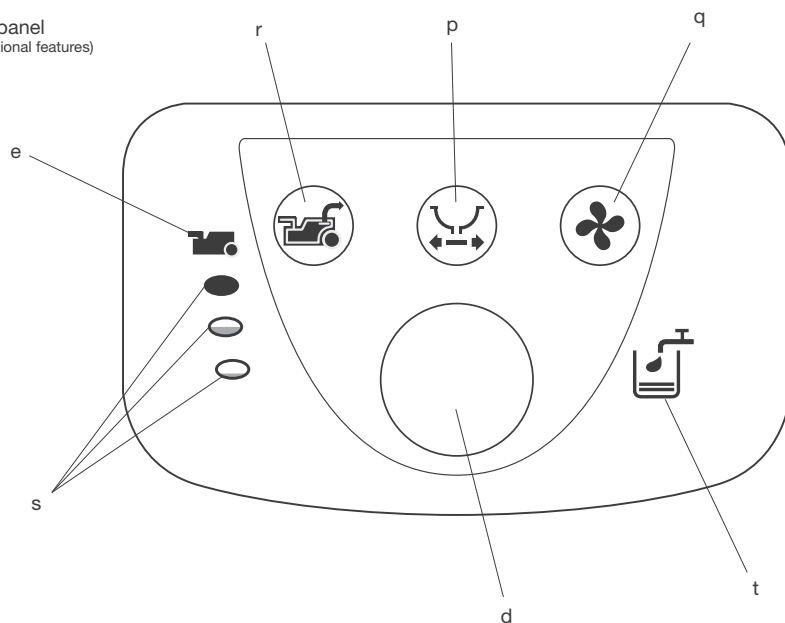

GB Instructions for use

INTRODUCTION

The Thetford Cassette Toilet is a high quality product. The toilet forms an integral part of your caravan or camper bathroom, thanks to its functional design which combines modern styling and ease of use. The C-250 Cassette Toilet is manufactured from high quality synthetic materials which makes it a durable, user and maintenance friendly toilet.

The toilet is made up of two parts: a permanently fixed part and a waste-holding tank that is accessible from the outside. The removable waste-holding tank is located under the toilet bowl and can be removed via a door on the outside of the caravan or camper. The Thetford Cassette Toilet is the solution to the sanitary problem in your caravan or camper!

The operating instructions in this owner's manual cover Thetford Cassette Toilet models C-250S, C-250CS (models connected to the vehicle's central water tank) and C-250CWE (model with its own flush-water tank). There are differences in the use of these models. Please ensure that you follow the instructions that apply to your toilet model.

PARTS

- a) Removable seat and cover
- b) Swivelling toilet bowl
- c) Blade handle
- d) Flush button
- e) Waste-holding tank level indicator
- f) Water filling door (only if toilet has own flush-water tank)
- g) Rotating emptying spout
- h) Automatic pressure release vent
- i) Sliding cover
- j) Removable mechanism
- k) Vent plunger
- l) Pull-out handle
- m) Wheels
- n) Blade opener
- o) Access door to waste-holding tank

Additional Features

- p) Electric blade opener
- q) Electric Ventilator
- r) Waste Pump-Out system
- s) Waste-holding tank multi-level indicator
- t) Flush-water tank level indicator (only if toilet has its own flush-water tank)

Note. Some additional features can be bought at Thetford dealerships.

PREPARING FOR USE (standard)

1. Open the access door on the outside of your caravan or camper.
2. Remove the waste-holding tank by pulling the safety catch (which holds the tank in place) upwards.
3. Pull the waste-holding tank outward. Tip it slightly and take the tank fully out.

4. Place the tank upright and turn the rotating emptying spout upwards.
5. Remove the cap, with the measuring cup inside, from the emptying spout and pour the correct dosage of Thetford toilet fluid (see product label) into the waste-holding tank. This avoids unpleasant smells and keeps the inside of the tank clean. Next add approximately 2 litres of water - enough to ensure that the bottom of the waste-holding tank is covered. For more information on Thetford toilet fluids, see last page of this manual. Screw the cap back onto the emptying spout and turn back to its original position.

Note. The emptying spout measuring cap is supplied in the same packaging as this manual.

Warning! Never add toilet fluid directly via the blade or the toilet bowl as this could damage the lip seal of the waste-holding tank. Always pour the fluids via the emptying spout.

6. Slide the waste-holding tank back into its original position via the access door. Make sure that it is secured with the safety catch. Close the access door and lock it. Your Thetford toilet is now ready to use.

Warning! Never use force if you cannot get the tank back into place easily. This may cause serious damage. If blockage occurs, always check if the blade handle is in the correct (closed) position.

7. For toilets with own flush-water tank: Open the water filling door and fill the flush-water tank with the correct dosage of Aqua Rinse. This Thetford toilet fluid keeps the flush water fresh and improves the flushing. Next, fill up the flush-water tank with clean water (approximately 8 litres) using a jerry can or hose. Close the door and lock it. Your toilet is now ready to use.

Note. Use fresh (tap) water for the water tank.

Preparing for use with Additional Features

8. Electric Ventilator: Open the access door on the outside of your caravan and remove the waste-holding tank (as described above).
9. Remove the filter housing cover and if no filter is present, peel off the sticker lids on the filter and place the new filter into the filter housing. Place back the cover of the filter housing.
Note. Clearly read the instructions on the filter on how to place the filter in the filter housing

USING THE TOILET (standard)

10. Turn the bowl to the desired position with the cover closed and using both hands.
11. To activate the control panel, press the flush-button once. The control panel display will stay activated for approximately 5 minutes. Run water into the bowl by pressing the flush knob briefly or open the valve blade by turning the handle anti-clockwise. Your Thetford toilet is now ready for use.
12. After use, open the valve blade (if still closed) by turning the handle anti-clockwise. Flush the toilet by pressing the flush knob for several seconds. **TIP!** The flush of your toilet will be more effective if you pulsate the flush

GB

by pressing the flush button several times in a row. Close the valve blade after use.

Note. To guarantee the best functioning of your Thetford toilet we recommend to use Thetford additives and Thetford Aqua Soft toilet paper.

Important Warning Notice! Please do not travel with a flush-water tank that is too full (we advise empty, but for sure not filled more than half-full). Do not travel with water in the toilet bowl. Failure to adhere to this notice may result in water damage to your caravan or motor home. Please avoid to travel with a waste-holding tank that is more than 3/4 full. This may cause leakage through the venting system.

Using the toilet with Additional Features

13. Electric blade opener: Push the electric blade button on the control display to electrically open or close the blade. In the case of failure, you can manually open or close the blade by sliding the small handle under the toilet bowl sideways.

Note. To guarantee the best functioning of the Electric Blade Opener it should be operated without sitting on the toilet.

14. Electric Ventilator: The ventilator automatically starts when the control panel is activated (by pressing the flush button) and will automatically shut off after approximately 5 minutes. The Electric Ventilator Indicator will flash until automatic shut-off occurs. If you want to stop the ventilator, press the Electric Ventilator button. If you want to re-start the ventilator, press the button again (the LED will start flashing again).

15. Flush-water tank level indicator (only for toilets with own flush-water tank): When the flush-water tank level indicator lights up, refill the flush-water tank, as only about 1L of water is left in the tank, which is sufficient for approximately 2 flushes.

EMPTYING

The waste-holding tank requires emptying when the red light (LED) on the toilet control display lights up. The red light lights up, when the waste-holding tank only has capacity for approximately 2 more litres, which is no more than two to three further uses.

Make sure that the blade is closed. Open the access door located outside the vehicle, pull the safety catch on the waste-holding tank upwards and remove the waste-holding tank by pulling the tank towards you.

16. Place the waste-holding tank in an upright position (pull-out handle at the top, wheels at the bottom).
17. Release the handle from the snaps, pull the handle up and wheel the waste-holding tank to an authorized waste disposal point.
18. Push the handle back into its locked position. Turn the emptying spout upwards and remove the cap from the spout. Hold the waste-holding tank in such a way that during emptying you can operate the vent plunger with your thumb. To empty the tank without splashing, depress the vent plunger while emptying the tank. After

emptying, rinse the tank and blade thoroughly with water.

Warning! Do not seriously shake the tank or use high pressure water cleaners. This may cause damage to the tank's interior.

Note. The vent plunger should only be depressed once the emptying spout is pointing downwards. Prepare the toilet for re-use if required. Slide the waste-holding tank into the toilet and close the access door.

Emptying with Additional Features

19. Waste-holding tank multi-level indicator: The lower LED indicates that the waste-holding tank is almost empty; the middle LED indicates that it is more than half full; when the top LED is lit, the tank needs emptying as it can only take 2 - 3 further uses.

Note. The red LED will flash when the waste-holding tank is not present or not in the right position.

20. Waste Pump-Out system: When activating the control panel this feature automatically lights up. When the waste-holding tank level indicator illuminates, press the Waste Pump-Out button to pump out the waste from the holding tank into the vehicle's waste tank. The button will flash while the waste is being pumped and will stop automatically (after approximately 2 minutes) when all waste has been transferred. If the vehicle's waste tank is full, the Waste Pump-Out light will flash rapidly and no pump-out will be possible until the central tank is emptied. (Check the level of the vehicle's waste tank regularly). After the waste-holding tank has been emptied, there will be approximately 1.5 litres of waste left in the tank. This is normal. Add 2 litres of water and a correct dosage of Thetford toilet fluids to the waste-holding tank.

Important! Before activating the Waste Pump-Out system, make sure that the central waste-holding tank has still enough capacity (approximately 18L)

Important! For a proper breakdown of the waste and functioning of the Waste Pump-Out system it is important to use Thetford additives and Aqua Soft toilet paper.

Important! It is vital that the correct amount of Thetford toilet fluid is added to ensure the proper breakdown of the waste in the waste-holding tank. Only use the system when the waste-holding tank is filled. Using the system too often on an empty waste-holding tank can cause damage to the pump, which could cause the system to fail.

CLEANING AND MAINTENANCE

The toilet should be cleaned and maintained regularly, depending on the amount of use. To clean Thetford toilets, we advise using water and Thetford Bathroom Cleaner & Thetford Toilet Bowl Cleaner.

Note. Never use bleach, vinegar or other powerful household cleaners that contain these substances. These may cause permanent damage to the seals and other toilet components.

Toilet Bowl

- Squirt Thetford Toilet Bowl Cleaner into the toilet bowl and use Thetford Bathroom Cleaner for the outside of the toilet. Read the product instructions before use.
- Flush the toilet bowl with water and wipe down the rest of the toilet with a damp cloth.
- Clean seat and cover. The seat and cover can easily be removed: Lift the seat and cover assembly and pull the round pins (inside the assembly) outwards from the pin holes. After cleaning, replace the seat and cover by positioning the round pins in front of the pin holes and push the lid and seat downwards.
- To keep your flush water fresh and to prevent deposits from forming in your toilet bowl, add a correct dosage of Aqua Rinse in your flush-water tank, if present, on your toilet.

Tip! For a really shining toilet, dry with a soft dry cloth after cleaning.

Waste-holding tank

For normal and effective use of your waste-holding tank, Thetford has developed a number of different toilet fluids. Thetford toilet fluids suppress smells, reduce formation of gas, promote breakdown of toilet waste and increase the life span of a mobile toilet. See page 50 for more information (=matrix). We advise a thorough cleaning of the waste-holding tank once each season. Next to using Thetford's Cassette Tank Cleaner, the powerful cleaning agent for the periodical cleaning of the waste-holding tank of your toilet, we suggest the following:

- Remove the removable mechanism from the waste-holding tank by turning it anti-clockwise and rinse it under a tap.
- Remove the cover plate from the automatic pressure release vent by prising it up using a small screwdriver. Use one hand to push the automatic pressure release vent open while holding the float of the automatic pressure release vent on the inside of the tank with the other hand. Push the float upwards, turn it 180 degrees and remove it from below. Remove the rubber seal underneath the float. Rinse the float and rubber seal under a tap. Replace the rubber seal and float for the automatic pressure release vent using the same method in reverse.
- If your toilet has a Waste Pump-Out system, remember to periodically clean the connecting mechanism between waste-holding tank and Waste Pump-Out system and treat it with Thetford High Grade Seal Lubricant.

The rubber seals in the toilet (the lip seal, the mechanism seal, the automatic pressure release vent seal and the cap seal) should be regularly cleaned with water and treated with Thetford High Grade Seal Lubricant. This will ensure that the seals remain flexible and in good condition. If the toilet is not to be used for any length of time, it is important to treat the seals with Thetford High Grade Seal Lubricant after cleaning.

Note. Never use vaseline or any vegetable oil except olive oil. These may cause leakage or malfunction. The lip seal is a part of the toilet that is subject to wear. Depending upon the extent and manner of use, the seals will become less effective and will need replacing periodically.

Cleaning and maintenance for optional features

- Electric Ventilator: The filter of the Electric Ventilator needs to be renewed periodically. After approximately 4 full weeks of use, the filter loses its absorption power.
- Waste Pump-Out system: To ensure optimal functionality of the Waste Pump-Out system, periodical maintenance of the tube and pump is recommended. After emptying the waste-holding tank completely, fill it with clean water and empty it by pumping the water to the central waste-holding tank. Do this twice. This will clean the pump and the hose. Do this once every 3 weeks when on holiday. Every 6 weeks fill the waste-holding tank once with clean water, empty it, and once with clean water and Thetford Cassette Tank Cleaner and empty it. This should ensure proper operation of the system.

WINTER OPERATION

You can use your Thetford Cassette Toilet as normal in cold weather as long as the toilet is situated in a heated location. If there is a risk of freezing we advise that the toilet is drained by following the instructions under 'Storage' or use MPG (Mono Propylene Glycol)

STORAGE

It is important that you follow the instructions below if you do not expect to use your Thetford toilet for a long (winter) period.

- If your toilet is connected to your vehicle's central drinking water tank, please empty this tank first. When the central drinking water tank is empty, activate the Control Panel by pressing the flush button. Open the blade and press the flush button until water stops flowing into the bowl. Close the blade. Open the access door on the outside of your caravan or camper and empty the waste-holding tank at an authorized waste dump. Follow the instructions for cleaning and maintenance. To allow the waste-holding tank to dry, do not place the cap back on the emptying spout of the tank.

21. If the toilet has its own flush-water tank, place a sufficiently large bowl under the drain tube to catch the remaining water from the flush-water tank and remove the drain plug. When no more water exits, put the drain plug on the drain tube, put it back in its original position and close the access door. If the toilet is connected to the vehicle's water tank, please follow your vehicle's instructions for draining the central water system. If your toilet is optionally featured with a Waste Pump-Out system, take out the waste-holding tank and completely clean it (see Cleaning and Maintenance) including the holding tank cover and docking part. After cleaning, fill it with fresh water, put it back and empty it via the Waste Pump-Out system. Once more fill the tank with fresh water and Thetford Cassette Tank Cleaner, put it back and again empty it via the Waste Pump-Out system. Finally for thorough cleaning fill the cassette once more with fresh water and use the Waste Pump-Out system to empty it. Then remove the waste-holding tank and empty it completely. To allow the waste-holding tank to dry,

do not place the cap back on the emptying spout of the tank. Don't forget to empty your vehicle's central waste tank!

THETFORD WARRANTY

Thetford BV offers the end users of its products a three year guarantee. In the case of defects within the guarantee period, Thetford will repair or replace the product. In this instance, the costs of replacement, labour costs for the replacement of defective components and/or the costs of the parts themselves will be paid by Thetford.

1. To claim under this guarantee, the user must take the product to a service centre recognised by Thetford. The claim will be assessed there.
2. Components replaced during repair under guarantee become the property of Thetford.
3. This guarantee does not prejudice current consumer protection law.
4. This guarantee is not valid in the case of products that are for, or are used for, commercial purposes.
5. Guarantee claims falling into one of the following categories will not be honoured:
 - The product has been improperly used, or the instructions in the manual have not been followed
 - The product has not been installed in accordance with the instructions
 - Alterations have been made to the product
 - The product has been repaired by a service centre not recognised by Thetford
 - The serial number or product code has been changed
 - The product has been damaged by circumstances outside the normal use of the product

CUSTOMER SERVICE

Please visit our website if you require further information or have any questions about your toilet: **www.thetford-europe.com**. The information available includes frequently asked questions, trouble shooting, instructions for repair, tips, and a list of Thetford Dealers and Service Centres near you. If you still have questions or remarks, please contact the Customer Service Department in your country (see the addresses on the back of this manual).

LIABILITY

Thetford is not liable for loss and/or damage caused directly or indirectly by use of the toilet.

FR Instructions d'utilisation

INTRODUCTION

La toilette à cassette Thetford est un produit de haute qualité. Grâce à sa conception fonctionnelle qui conjugue modernité et facilité d'utilisation, cette toilette fait partie intégrante de la salle de bains de votre caravane ou camping-car.

La toilette à cassette C-250 est fabriquée à partir de matériaux synthétiques de haute qualité, qui en font un produit durable, simple d'emploi et facile à entretenir.

La toilette se compose de deux parties : une partie fixe montée à demeure et un réservoir à matières accessible depuis l'extérieur. Le réservoir à matières amovible est situé sous la cuvette et peut être retiré par le biais d'une trappe située sur l'extérieur de la caravane ou du camping-car. La toilette à cassette Thetford est la solution idéale au problème des sanitaires dans votre caravane ou camping-car !

Les instructions d'utilisation figurant dans le présent manuel concernent les modèles de toilette à cassette Thetford C-250S, C-250CS (modèles raccordés au réservoir d'eau central du véhicule) et C-250CWE (modèle doté d'un réservoir d'eau propre). Ces modèles présentent certaines différences d'utilisation. Assurez-vous de suivre les instructions correspondant à votre modèle de toilette. Les pièces identifiées par des lettres sont illustrées sur la première page de ce manuel. Les actions à effectuer, identifiées par des numéros, sont illustrées sur la dernière page.

PIECES

- a) Siège et couvercle amovibles
- b) Cuvette pivotante
- c) Poignée d'ouverture et de fermeture du clapet
- d) Bouton de chasse d'eau
- e) Indicateur de niveau du réservoir à matières
- f) Trappe de remplissage d'eau claire (toilettes dotées d'un réservoir d'eau propre uniquement)
- g) Bras de vidange orientable
- h) Event automatique
- i) Couvercle coulissant
- j) Mécanisme amovible
- k) Bouton-poussoir de prise d'air
- l) Poignée d'extraction
- m) Roulettes
- n) Clapet
- o) Trappe d'accès au réservoir à matières

Fonctions supplémentaires

- p) Clapet électrique
- q) Ventilateur électrique
- r) Système de transfert des matières
- s) Indicateur multi-niveau du réservoir
- t) Indicateur de niveau bas du réservoir d'eau propre (toilettes dotées d'un réservoir d'eau propre uniquement)

Remarque. Vous pouvez acquérir certaines fonctions optionnelle chez votre revendeur Thetford.